

Link Union Station (Link US) Project

Revised Notice of Intent (NOI) Scoping Meeting

NEPA Environmental Impact Statement

October 8, 2020



Link US – Revised NOI Scoping Meeting

Meeting Agenda and Schedule

1. Meeting Schedule (6–8pm)

- Live Presentation: 6–6:30pm
 - Introductions
 - Presentation by Metro
 - Rules for Oral Public Comment
- Public Oral Comments: 6:30–8pm

2. Meeting Access

- Virtual open house (metro.net/linkus)
- Web Link: <https://bit.ly/33aUWj6>; Webinar ID: 824 7060 0907; Passcode: 454631
 - Enlace: <https://bit.ly/35ktlym>; ID de seminario web: 992 6797 8668; Contraseña: 671633
 - 网站链接 : <https://bit.ly/32c3hDO>; 网站编号: 714 1090 3307; 密码 : 747576
 - ウェブリンク: <https://bit.ly/3hz3Vj8>; ウェビナーID : 910 9789 3128; パスコード: 249710

Written comments must be received on or before October 19, 2020

Link US – Revised NOI Scoping Meeting

Meeting Agenda and Schedule

1. Introduction and Background
2. Purpose of Revised NOI Scoping Meeting and NEPA Process
3. Link US Project Overview
4. Malabar Yard Off-Site Infrastructure
5. How to Submit Your Comments
6. Public Oral Comments

Introduction and Background

Agencies Involved

1. Local Project Sponsor – Metro
2. NEPA Lead Agency – California High-Speed Rail Authority (CHSRA)
3. NEPA Cooperating Agencies:
 - California Department of Transportation (Caltrans)
 - Southern California Regional Rail Authority (Metrolink)
4. NEPA Participating Agencies:
 - Federal Transit Administration (FTA)
 - City of Los Angeles
5. Other Agencies and Partners Involved:
 - California State Transportation Agency (CalSTA)
 - City of Vernon
 - BNSF Railway

Introduction and Background

Environmental Process Timeline

2016

- May - NOI issued for preparation of Joint Environmental Impact Statement (EIS)/Environmental Impact Report (EIR) (FRA and Metro: Joint Lead Agencies)

2018

- Fall - Standalone EIR initiated

2019

- January to March - Draft EIR circulated for 45-day public review
- June - Final EIR certified
- July - CHSRA designated as NEPA Lead Agency for Link US Project (pursuant to executed NEPA Assignment MOU between FRA and State of California)
- August – NEPA EIS reinitiated for Link US Project

2020

- September to October - Revised NOI released for 30-day public review

NEPA Process

Purpose of Revised NOI Scoping Meeting

1. Inform public and agencies of the following changes:
 - Removal of storage tracks at the BNSF West Bank Yard by the Los Angeles River and south of Los Angeles Union Station
 - New off-site infrastructure at the BNSF's Malabar Yard in the City of Vernon
2. Inform the public and agencies of the Revised NOI 30-day public comment period (September 18, 2020 through October 19, 2020)
3. Solicit public and agency input on the following:
 - Scope of the Draft EIS
 - Scope of analysis of the proposed action, including the range of alternatives

NEPA Process

Key NEPA Environmental Review Milestones

We Are Here



MILESTONE I

- Revised NOI
- 30-day Public Scoping Period
- Public Scoping Meeting

MILESTONE II

- Release Draft EIS
- Public Comment Period
- Public Hearing

MILESTONE III

- Publish Final EIS
- Response to Comments

MILESTONE IV

- Record of Decision (ROD)

Continuous Public Involvement within Each Milestone

NEPA Process

Section 106 Consultation Process

1. CHSRA and Metro are complying with the National Historic Preservation Act (NHPA) in parallel with the NEPA process
 - Any parties interested in becoming a Section 106 consulting party should inform CHSRA or Metro in their comments
2. Local agencies currently participating in the Section 106 process include:
 - Caltrans District 7
 - City of Los Angeles Planning Department
 - City of Los Angeles Office of Historic Resources
 - City of Los Angeles Cultural Heritage Commission
 - City of Vernon

Link US Project Overview

Major Project Components

1. New Lead Tracks and Elevated Rail Yard
2. New Passenger Concourse
3. Run-Through Tracks (up to 10 tracks south of Los Angeles Union Station)
4. Malabar Yard (City of Vernon)



Link US Project Overview

NEPA EIS Build Alternatives

Build Alternative 1

1. Shared Lead Tracks
2. Expanded Passageway
3. Up to 10 Run-Through Tracks (No Loop Track)
4. Malabar Yard Off-Site Infrastructure

Build Alternative 2

1. Dedicated Lead Tracks
2. At-Grade Passenger Concourse
3. Up to 10 Run-Through Tracks (With Loop Track)
4. Malabar Yard Off-Site Infrastructure

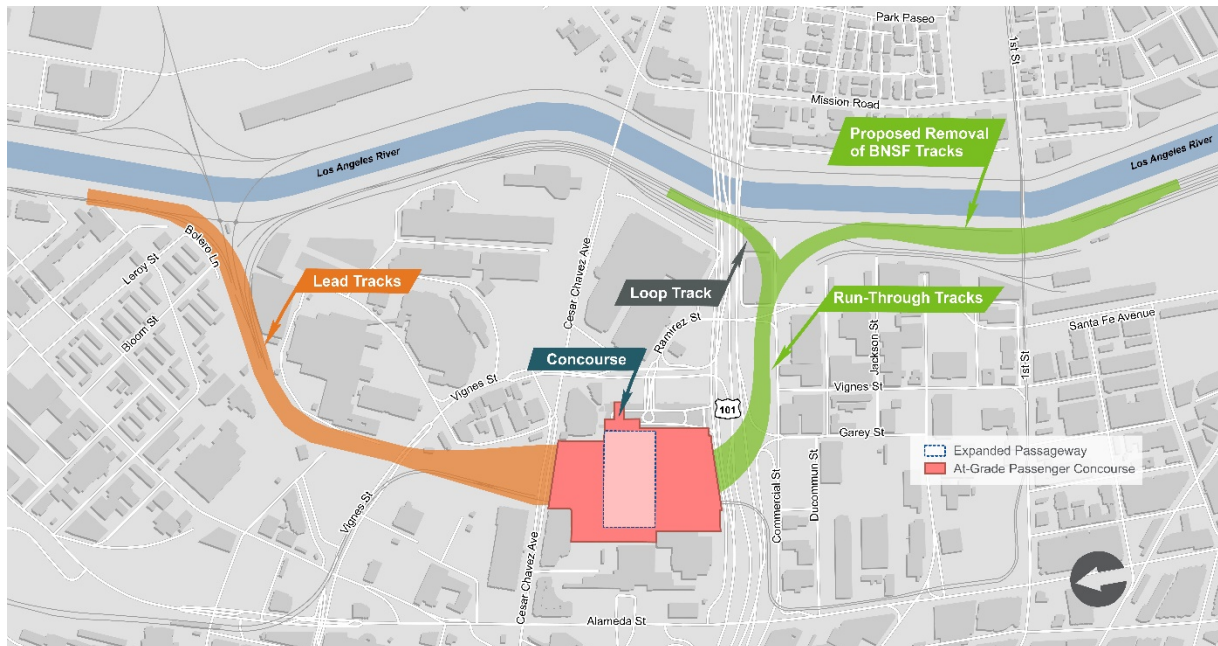

Link US Project Overview

BNSF West Bank Yard Permanent Loss of Storage Tacks

1. Allows accommodation of future HSR trains to connect to main line tracks
2. Results in a permanent loss of approx. 5,000 feet of storage tracks at the BNSF West Bank Yard north of First Street

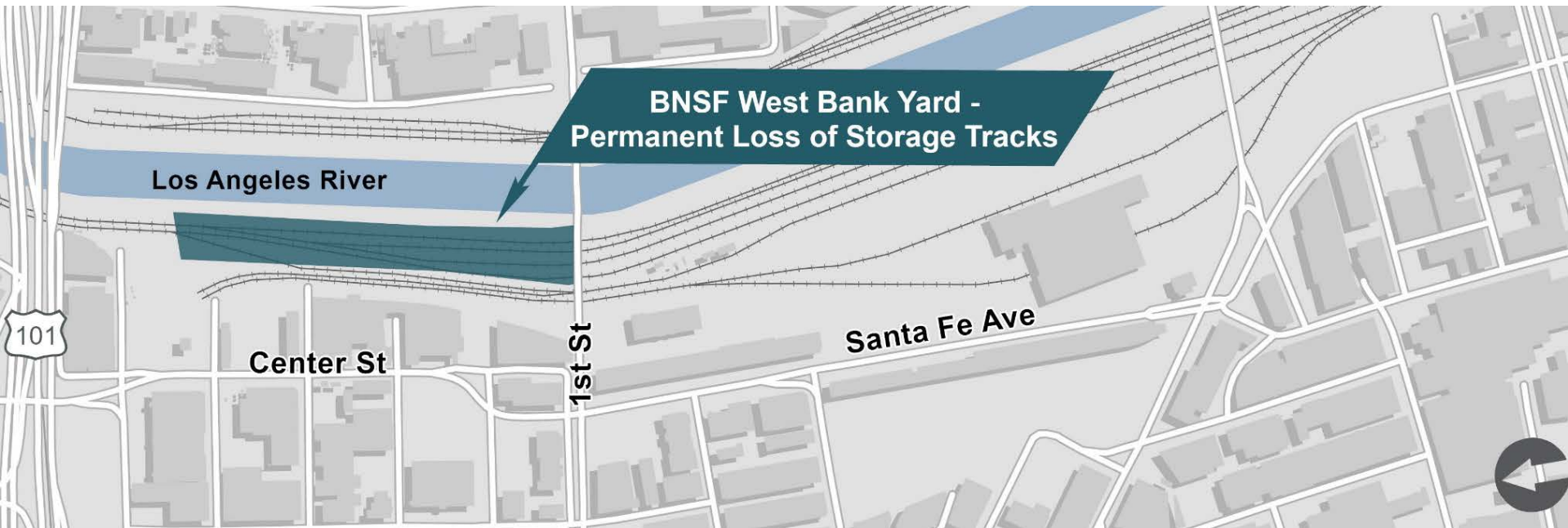

Malabar Yard Off-Site Infrastructure

Project Area Overview (City of Vernon)

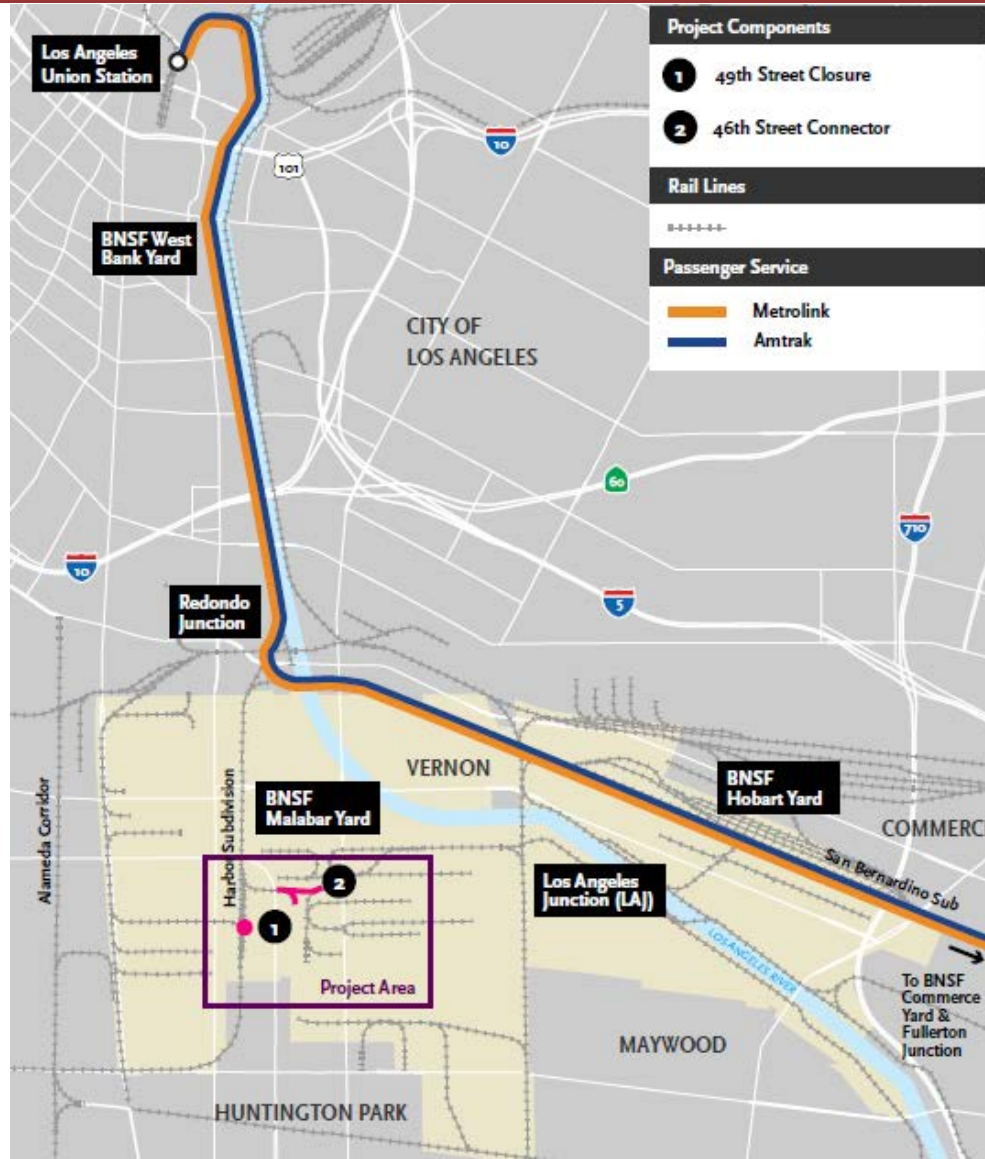

Malabar Yard Off-Site Infrastructure

Revised NOI - BNSF Malabar Yard

1. 49th Street Closure

- Closure of the at-grade railroad crossing at 49th Street

2. 46th Street Connector

- New 1,000-foot track connection along 46th Street



Malabar Yard Off-Site Infrastructure

49th Street Closure (City of Vernon)

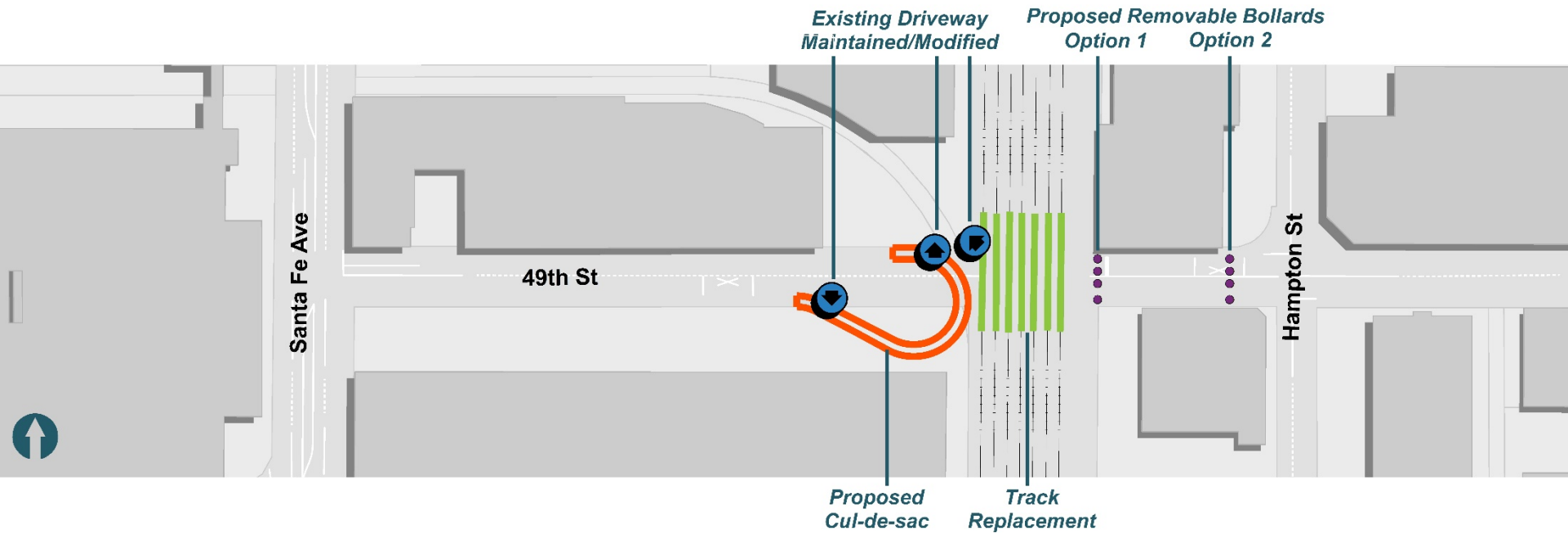

Draft - 10% Preliminary Design (Concept Only)

Malabar Yard Off-Site Infrastructure

46th Street Connector (City of Vernon)

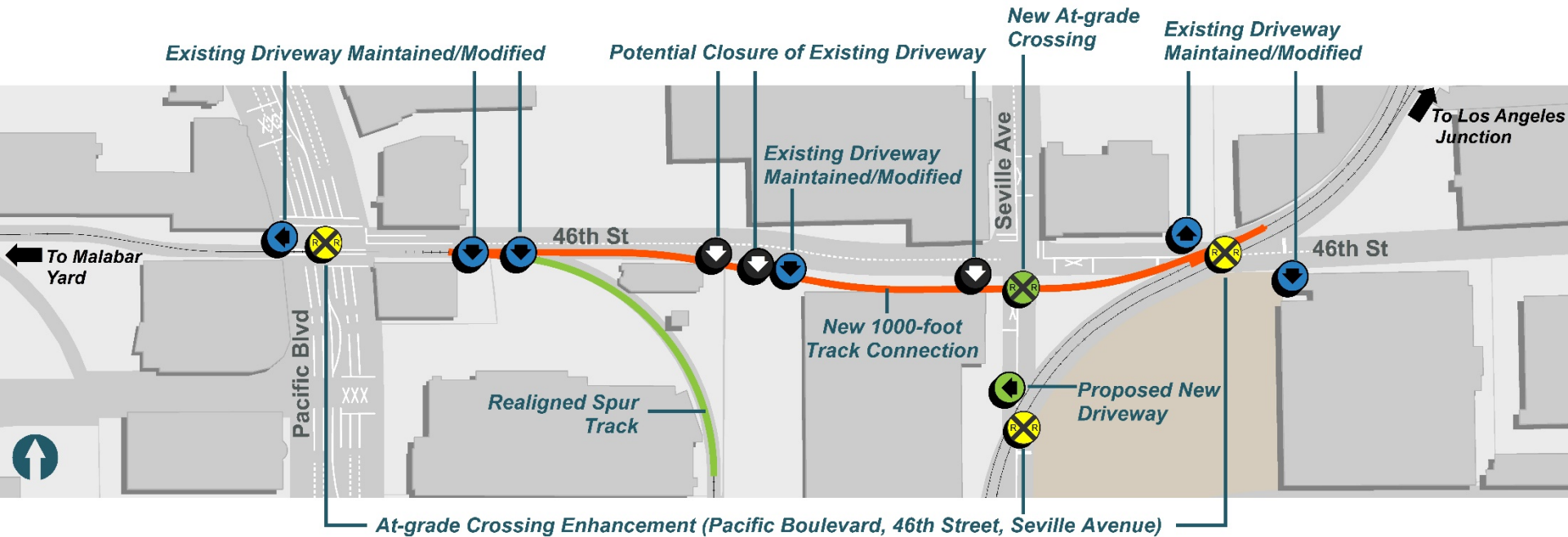

Queuing Analysis will consider:

1. Up to 11 daily trains into/out of Malabar Yard by 2040
2. Trains approximately 7,000 to 10,000 feet long
3. Majority of trains traveling outside of AM and PM peak periods (7 am to 9 am and 4 pm to 6 pm)

Malabar Yard Off-Site Infrastructure

Traffic Study

1. Freeway Access to Businesses Maintained
2. Vernon Avenue, Santa Fe Avenue, and Leonis Boulevard provide direct access to Interstate 110, 10, and 710

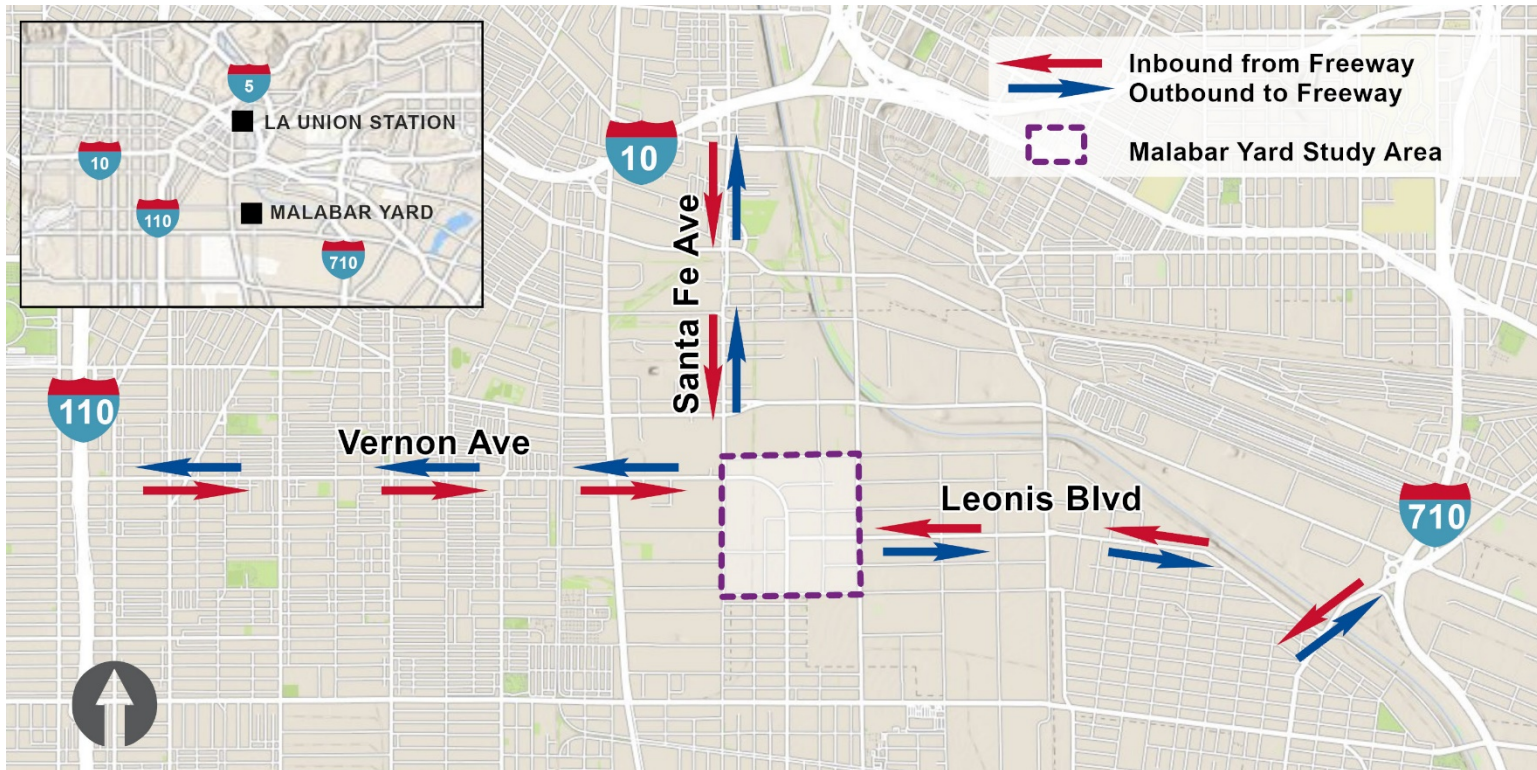

Malabar Yard Off-Site Infrastructure

Traffic Study

1. Level of Service (LOS) Analysis:

- 10 Intersections
- 11 Roadway Segments

2. Circulation and Access Analysis:

- 16 Driveways

3. Queuing Analysis:

- 4 Railroad Crossings will consider:
 1. Number of BNSF trains into/out of Malabar Yard each day using the 46th Street connector
 2. Train speed and length of trains
 3. Time of day when trains will operate

Traffic Study Area

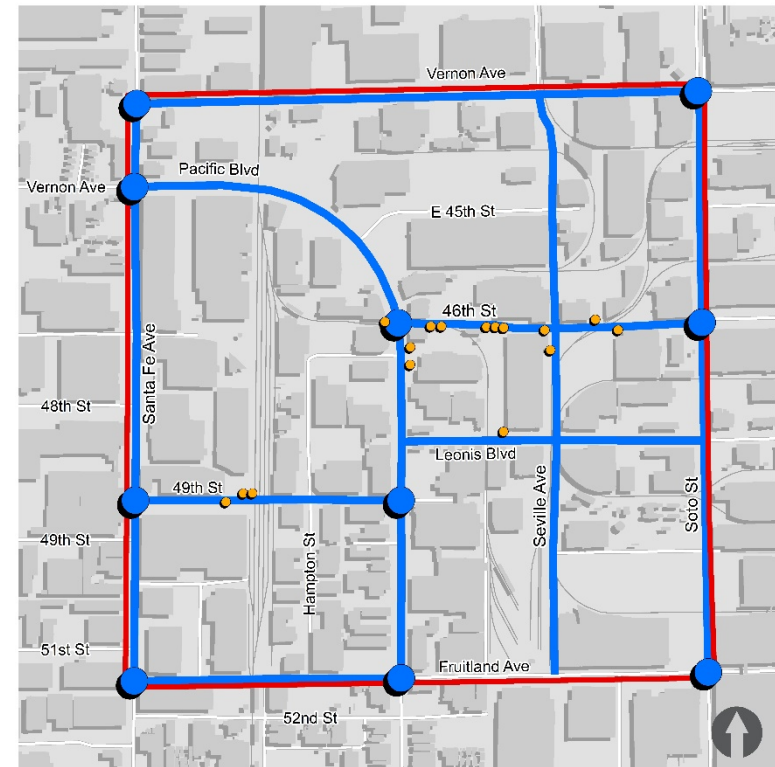
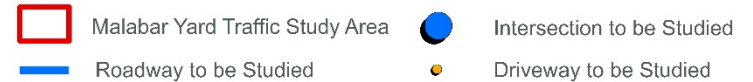

Malabar Yard Off-Site Infrastructure

49th Street Closure – Proposed Traffic Circulation Routes

Access to/from properties east of Malabar Yard (from/to Santa Fe Avenue):

- Via Hampton Street and Pacific Boulevard to Santa Fe Avenue
- Via 49th Street and Pacific Boulevard to Santa Fe Avenue
- Via Hampton Street, Fruitland Avenue and Pacific Boulevard to Santa Fe Avenue

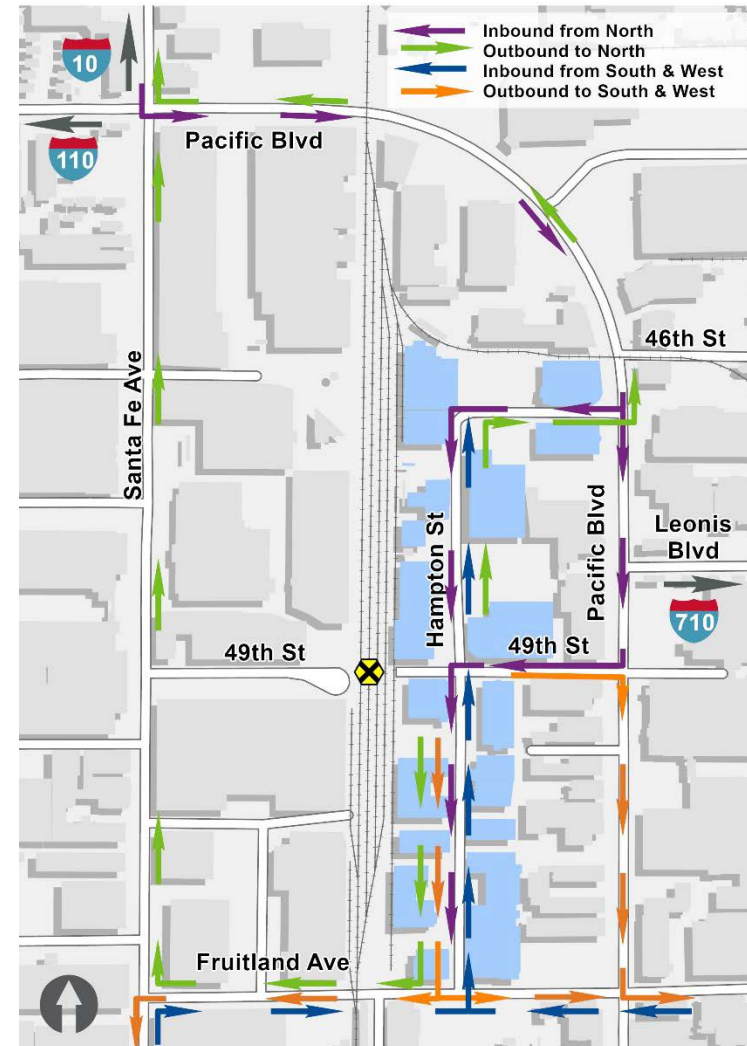

Malabar Yard Off-Site Infrastructure

49th Street Closure – Proposed Traffic Circulation Routes

Access to/from properties west of Malabar Yard (from/to Pacific Boulevard):

- Via Santa Fe Avenue to Pacific Boulevard
- Via 49th Street, Santa Fe Avenue, and Fruitland Avenue to Pacific Boulevard
- Via Santa Fe Avenue to Fruitland Avenue to Pacific Boulevard

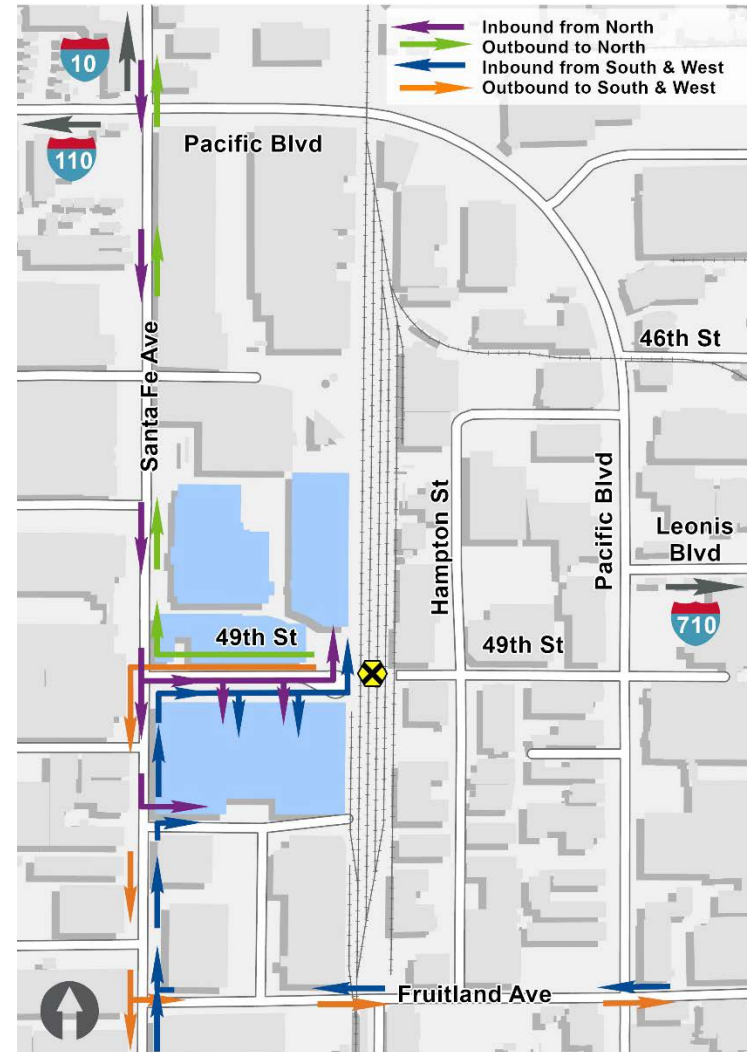

Link US Project Overview

Phasing and Funding



Phase A (Funded)

SEGMENT 1 – THROAT AREA

1. Rail signal, communications and track work
2. Utility relocation

SEGMENT 2 – COMMERCIAL & CENTER ST

1. Property acquisition
2. Utility relocation

SEGMENT 3 – VIADUCT & RUN-THROUGH

1. Viaduct structure over US-101 (full width)
2. Two run-through tracks from Union Station Platform 4 to mainline tracks
3. Signal and communication

Phase B (Not-Funded)

SEGMENT 4 – RAIL YARD/CONCOURSE AREA

1. Raising of the rail yard, new lead tracks, new platforms, as well as new stairs, escalators
2. Concourse-related improvements
3. Add remaining run-through tracks (10 total)

Thank You – Stay Involved

Link US Project Team

Dan McKell, CHSRA, NEPA Assignment Manager

Jeanet Owens, P.E., Metro, Senior Executive Officer, Regional Rail

Vincent Chio, P.E., Metro, Director, Regional Rail

Danielle Valentino, Metro, Community Relations Manager

For additional information,
please contact us at:



213.922.2524



LinkUnionStation@metro.net



www.metro.net/linkus



facebook.com/regionalrail



facebook.com/losangelesmetro



How to Submit Comments on New Project Elements

Public Comment Period: September 18, 2020 through October 19, 2020

Commenting during the live event

1. Verbally in the Zoom Meeting
2. By Phone via call in number
3. Comment by chat in the Zoom meeting
4. Form at comment desk in Virtual Meeting Room at linkunionstation.com

Commenting after the live event

1. Email (see address below)
2. By Phone: 213.922.2524
3. Form at comment desk in Virtual Meeting Room at linkunionstation.com

Written Comments can be sent to:

1. Dan McKell, NEPA Assignment Manager
California High-Speed Rail Authority, Environmental Services Branch
770 L Street, Suite 620, Sacramento, CA 95814
Dan.McKell@hsr.ca.gov
2. Vincent Chio, Director of Program Management
Los Angeles County Metropolitan Transportation Authority, Regional Rail
One Gateway Plaza (Mail Stop 99-17-2), Los Angeles, CA 90012
linkunionstation@metro.net



How to Comment or Ask Questions

Making Oral Comments Online or Via Phone

Online - via chat box or “raising your hand”

1. To raise your hand, click on the arrow next to the participants, find your name and click on the three dots located next to it.
 - There will be a “Raise Hand Option” to the right of the chat.
2. The project team will announce your name and unmute you to speak.
3. Please state your name or organization for the Court Reporter and speak clearly and directly into the microphone

Phone - via “raising your hand”

1. To raise your hand, press *9
2. The project team will announce the last four digits of your phone number when it is your turn to speak
3. Press *6 to unmute and mute yourself
4. Please state your name or organization for the Court Reporter and speak clearly and directly into the phone